

Bolt Tensioner

Series : BTS

Max. working pressure : 1500 bar

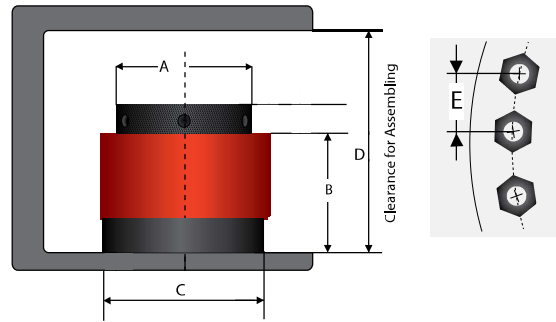

- Compact design, makes easy to fit in confined spaces.
- Models are available in metric and imperial sizes.
- Suitable for tightening multiple bolts at a time.
- Spring assisted piston retraction.
- Maximum piston stroke of 10mm except BT50 is 8mm.
- Suitable to operate with manual or air driven hydraulic pumps.
- Fitted with high pressure M/F couplers.

Load Cell	Stud Diameter		Tool Load		Hydraulic Area		A		B		C (A/F)		D	
	Imp	Metric	Lbs	kN	in ²	mm ²	in	mm	in	mm	in	mm	in	mm
BTS 0	3/4"	M20	35500	160	1.65	1067	2.6	66	3.7	93	2.5	63	5.5	142
	7/8"	M22											5.6	144
BTS 1	1"	M24	61950	280	2.89	1867	3.4	87	4.6	117	2.7	68	6.9	175
	1-1/8"	M27							4.6	117	2.7	68	7.0	178
BTS 2	1"	M24	99700	450	4.65	3001	4.1	103	4.7	120	2.8	72	7.1	181
	1-1/8"	M30							4.6	117	3.0	75	6.9	175
	1-1/4"	M33							4.6	117	3.0	75	7.0	178
	1-3/8"	M36							4.7	120	3.2	80	7.2	184
BTS 3	1-1/4"	M33	145950	660	6.82	4401	4.7	118	4.8	123	3.3	84	7.5	190
	1-3/8"	M36							5.0	126	3.5	89	7.7	196
	1-1/2"	M39							4.8	123	3.5	88	7.6	192
	1-5/8"	M42							5.0	126	3.8	96	7.8	198
BTS 4	1-1/2"	M39	223550	1000	10.34	6668	5.5	140.5	5.1	130	3.8	96	8.0	204
	1-5/8"	M42							5.2	133	4.1	105	8.3	211
	1-3/4"	M45							5.2	132	4.4	112	8.4	212
	1-7/8"	M48							5.3	135	4.5	114	8.6	218
BTS 5	2"	M52	331400	1500	15.50	10003	6.9	175.5	5.5	139	4.7	118	8.9	225
	2-1/4"	M56							5.6	142	4.5	114	9.1	231
	M60	5.7							145	4.7	120	9.3	236	
	2-1/2"	M64							5.8	148	4.7	120	9.8	248
BTS 6	2-3/4"	M72	553200	2500	25.84	16671	8.6	219	6.1	154	5.4	138	10.2	259
	3"	M76							6.3	161	5.4	138	10.3	262
	M80	6.3							161	6.0	153	10.8	273	
	3-1/4"	M85							6.6	167	6.1	156	11.2	284
BTS 7	3-1/2"	M90	708200	3200	33.06	21339	9.9	252	6.6	167	6.2	157	11.7	297
	4"	M100							6.9	171	7.2	182	12.1	308
BTS 7	3-1/2"	M90	708200	3200	33.06	21339	9.9	252	7.1	180	7.5	190	12.3	312
	M95	7.1							180	7.5	190	12.7	323	
	3-3/4"	M100							7.3	186	8.1	205	13.2	334
	4"	M100							7.3	186	7.9	200	13.3	341
BTS 7	3-3/4"	M100	708200	3200	33.06	21339	9.9	252	7.3	186	7.9	200	13.5	346
	4"	M100							7.6	192	7.9	200	13.9	356
BTS 7	3-3/4"	M100	708200	3200	33.06	21339	9.9	252	7.8	199	8.3	210	14.2	363
	4"	M100							7.8	199	8.3	210	14.2	363